

Illustrated Index

Transmission Housing

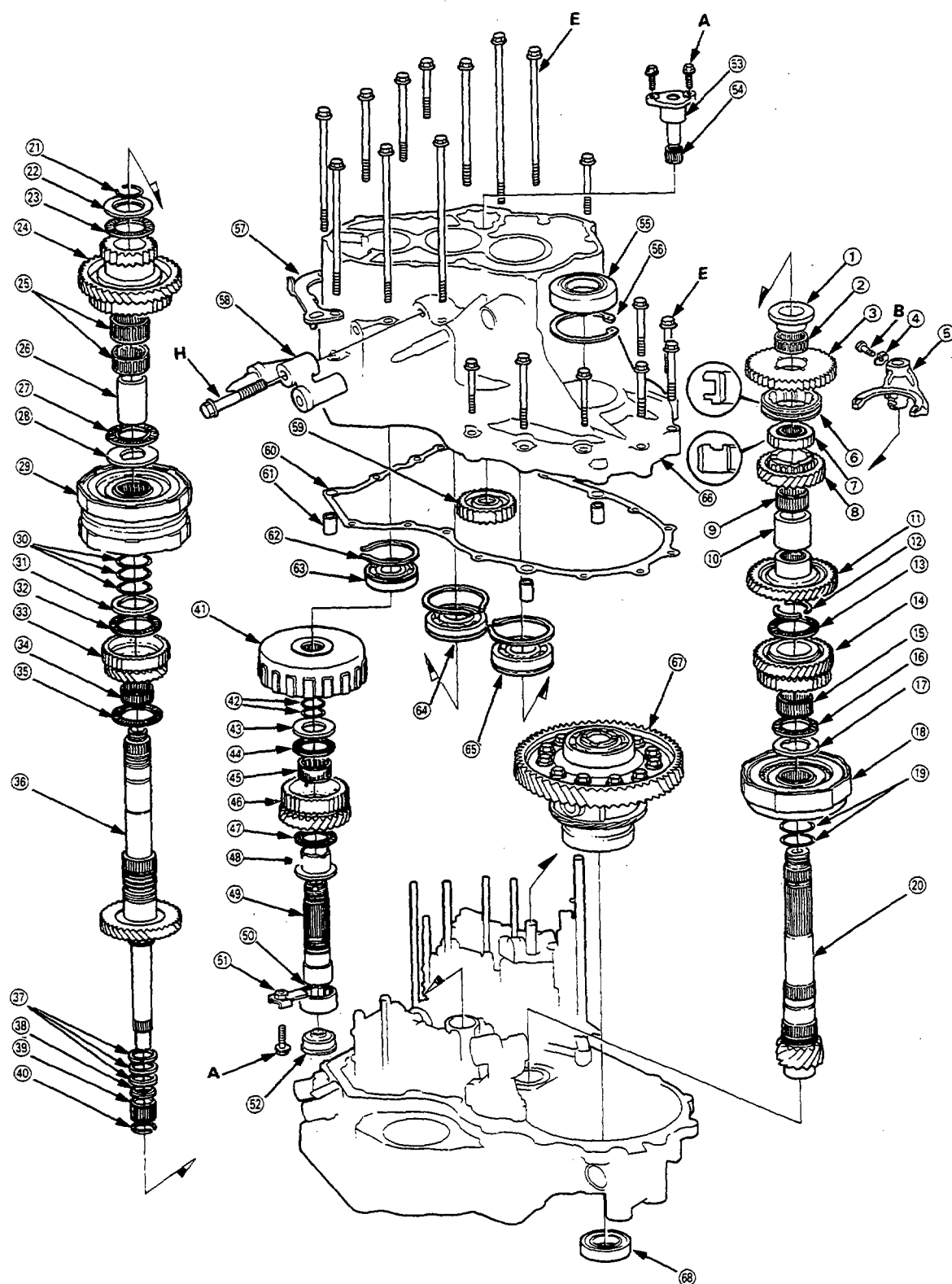



- | | |
|---|--|
| ① COUNTERSHAFT REVERSE GEAR COLLAR | ③⑥ MAINSHAFT |
| ② NEEDLE BEARING | ③⑦ SEALING RINGS, 35 mm |
| ③ COUNTERSHAFT REVERSE GEAR | ③⑧ SEALING RING, 29 mm |
| ④ LOCK WASHER Replace. | ③⑨ NEEDLE BEARING |
| ⑤ REVERSE SHIFT FORK | ④① SET RING |
| ⑥ REVERSE SELECTOR | ④② 1ST-HOLD CLUTCH ASSEMBLY |
| ⑦ REVERSE SELECTOR HUB | ④③ O-RINGS Replace. |
| ⑧ COUNTERSHAFT 4TH GEAR | ④④ THRUST WASHER |
| ⑨ NEEDLE BEARING | ④⑤ THRUST NEEDLE BEARING |
| ⑩ DISTANCE COLLAR, 28 mm Selective part | ④⑥ NEEDLE BEARING |
| ⑪ COUNTERSHAFT 2ND GEAR | ④⑦ SUB-SHAFT 4TH GEAR |
| ⑫ COTTERS | ④⑧ THRUST NEEDLE BEARING |
| ⑬ THRUST NEEDLE BEARING | ④⑨ SUB-SHAFT 4TH GEAR COLLAR |
| ⑭ COUNTERSHAFT 3RD GEAR | ④⑩ SUB-SHAFT |
| ⑮ NEEDLE BEARING | ⑤① NEEDLE BEARING |
| ⑯ THRUST NEEDLE BEARING | ⑤② NEEDLE BEARING STOPPER |
| ⑰ SPLINED WASHER Selective part | ⑤③ OIL GUIDE CAP Replace. |
| ⑱ 3RD CLUTCH ASSEMBLY | ⑤④ REVERSE IDLER GEAR SHAFT/HOLDER |
| ⑲ O-RINGS Replace. | ⑤⑤ NEEDLE BEARING |
| ⑳ COUNTERSHAFT | ⑤⑥ OIL SEAL Replace. |
| ㉑ SNAP RING | ⑤⑦ SET RING, 80 mm Selective part |
| ㉒ THRUST WASHER | ⑤⑧ TRANSMISSION HANGER |
| ㉓ THRUST NEEDLE BEARING | ⑤⑨ TRANSMISSION MOUNT BRACKET |
| ㉔ MAINSHAFT 4TH/REVERSE GEAR | ⑤⑩ REVERSE IDLER GEAR |
| ㉕ NEEDLE BEARINGS | ⑤⑪ TRANSMISSION HOUSING GASKET Replace. |
| ㉖ 4TH/REVERSE GEAR COLLAR | ⑤⑫ DOWEL PIN |
| ㉗ THRUST NEEDLE BEARING | ⑤⑬ SNAP RINGS |
| ㉘ THRUST WASHER | ⑤⑭ TRANSMISSION HOUSING SUB-SHAFT BEARING |
| ㉙ 2ND/4TH CLUTCH ASSEMBLY | ⑤⑮ TRANSMISSION HOUSING MAINSHAFT BEARING |
| ㉚ O-RINGS Replace. | ⑤⑯ TRANSMISSION HOUSING COUNTERSHAFT BEARING |
| ㉛ THRUST WASHER, 36.5 x 51 mm | ⑤⑰ TRANSMISSION HOUSING |
| Selective part | ⑤⑱ DIFFERENTIAL ASSEMBLY |
| ㉜ THRUST NEEDLE BEARING | ⑤⑲ OIL SEAL Replace. |
| ㉝ MAINSHAFT 2ND GEAR | |
| ㉞ NEEDLE BEARING | |
| ㉟ THRUST NEEDLE BEARING | |

TORQUE SPECIFICATIONS

Ref. No.	Torque Value	Bolt Size	Remarks
A	12 N·m (1.2 kgf·m, 8.7 lbf·ft)	6 x 1.0 mm	Special bolt
B	14 N·m (1.4 kgf·m, 10 lbf·ft)	6 x 1.0 mm	
E	33 N·m (3.4 kgf·m, 25 lbf·ft)	8 x 1.25 mm	
H	49 N·m (5.0 kgf·m, 36 lbf·ft)	12 x 1.25 mm	